

BRIEF SETUP

WIRELESS READER CONFIGURATION INSTRUCTIONS

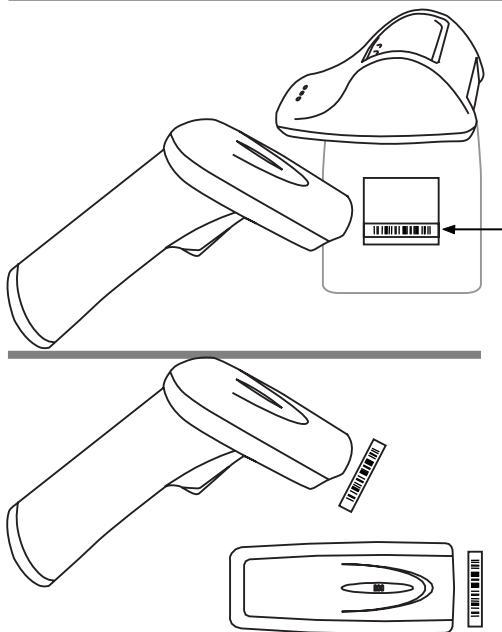

The reader is configured to default factory settings and is supplied with information that gives you a quick understanding of the product. More product details, additional support, or configuration options to your own preferences (by Universal menu book) will be updated at www.opticon.com

To enable the reader to communicate to another device, different steps can be taken, depending on the situation.

Overview of situations

- The address of the device must be configured in the reader. Possibly the address of the device needs to be retrieved first.
- To connect an Opticon reader to a third party dongle, the reader must be configured.
- In case a third party dongle is used, the address and pin code need to be configured manually. Consult your dongle's manual how to obtain the address and configure the pin code. You need this information to configure the bar code reader. The dongle's driver installs a serial port on the computer, which is used by the bar code reader to transmit the data.
- The reader can connect by scanning the other device's address label or by making the reader discoverable to the other device.
- To stop the connection manually use the special disconnection label.

CAUTION: This information is subject to change without prior notice.

Copyright 2006, Opticon Sensors Europe B.V. All rights reserved.

This manual may not, in whole or in part, be copied, photocopied, reproduced, translated or converted to any electronic or machine readable form without prior written consent of Opticon Sensors Europe.

THE GENERAL USE AND FUNCTIONING OF THE BAR CODE SCANNER IS DESCRIBED IN THIS DOCUMENT. ALSO GENERAL SETUP INSTRUCTIONS TO GET STARTED ARE DESCRIBED IN THIS DOCUMENT. FOR FURTHER INSTRUCTIONS CONSULT OPTICON OR YOUR LOCAL DEALER.

The necessary steps and instructions are explained on the next pages:

OPTICON

Overview of steps

Depending on the type of device to be connected, take the steps as further described. To configure the required options:

- scan the SET label
- scan the required option(s)
- scan the END label

After scanning the END label, the new settings are stored in non volatile memory.

Reader to Cradle

- connect by scanning (step 3 A)

PC to reader

- discover & connect (step 3 B)

Reader to PC / Other device

- retrieve device address (step 1)
- connect mode (step 2)
- security options (step 2 Optional)
- connect by scanning (step 3 A)

To disconnect the current reader:

- scan the disconnect label (step disconnect)

To return to default settings:

- scan the reset label (step reset)

[STEP 1] – RETRIEVE ADDRESS



The address is mostly displayed on the product label as a hexadecimal code (example: 00-11-F6-03-39-69). Otherwise consult the documentation of the device how to retrieve the device address code. To enable the reader to communicate to the other device, the reader must be configured with this code. The easiest way to do this is to create a barcode label of the hexadecimal code as described below.

– CREATE LABEL

Opticon provides a simple on-line application on <http://opticonfigure.opticon.com/bluetooth.asp> or <http://opticonfigure.opticon.com/ieee.asp>

- Type in the digits of the hexadecimal code in numbers and capital characters without dashes, dots and spaces (example: 0011F6033969).
- Submit the code into a barcode (example: ). You have to print the screen to have it available for scanning.

[STEP 2] CONNECT MODE

SET		ZZ
Connect to PC		CNPC
END		ZZ

[STEP 2 OPTIONAL] SECURITY OPTIONS

The third party dongle usually allows authentication, which means a PIN-code can be used to establish a secure connection. Note that the PIN-code is case sensitive, e.g. there is a difference between lower case and upper case (example: difference between 'a' and 'A').

Set PIN-code table

SET		ZZ
Set PIN-code label		PINS
Scan PIN-code input	see input tables	
End PIN-code label		PINE
END		ZZ

0		Q0
1		Q1
2		Q2
3		Q3
4		Q4
5		Q5
6		Q6
7		Q7
8		Q8
9		Q9

a		\$A
b		\$B
c		\$C
d		\$D
e		\$E
f		\$F

A		0A
B		0B
C		0C
D		0D
E		0E
F		0F

[STEP 3 A] CONNECT BY SCANNING

– CRADLE

- Scan the device address barcode on the bottom of the cradle.

– OTHER DEVICE

- Scan the address barcode that you just created in the on-line Opticon application (step 1).

[STEP 3 B] DISCOVER

Set the reader in discoverable and connectable mode:

- If an Opticon cradle is supplied: Place the reader in the cradle. The reader is discoverable while it is in the cradle.
- If no cradle is supplied: Scan the label to make the reader discoverable for 3 minutes.
(SET + END label not required):



Set the PC / Other device to discover the reader:

- The name of the reader will be displayed as Productname-xxxx. Example (OPL2724-3969)

CONNECT

Connect the PC / Other device to the reader:

- Follow the instructions of the device.
 - The application might ask for a PIN-code. In this case the 4 last reader name characters are entered into the application.
(Example: reader name is OPL2724-3969, required application PIN-code is 3969)
-

[STEP DISCONNECT]

(SET + END label not required):



[STEP RESET]

SET		ZZ
Reset		SO
END		ZZ
